

## MEMORANDUM

**To:** Minnehaha Creek Board of Managers  
**From:** Michael Hayman  
**CC:** James Wisker  
**Date:** 9/19/2014  
**Re:** Minnehaha Creek Reach 20 Restoration and Trail Initiative Update

---

### **Overview:**

Construction of the trail system at the Reach 20 Restoration was abruptly interrupted in early June due to the extensive rains and early summer flooding. Stream conditions remained high throughout the summer months, inundating the majority of the site and allowing for only minor boardwalk work to be completed. As conditions have begun to return to normal, staff and Blackstone Contractors have been working closely to reengage efforts onsite and adjust contract documents and schedules.

Approximately six to eight weeks of bituminous and granular trail construction remains. Weather permitting, all efforts will be made to complete this work prior to hard frost (late-November). Bituminous trail construction will be divided into three segments, thus allowing for areas that experienced prolonged inundation additional time to dry. This sequence of work will travel from west to east – Meadowbrook Road to Louisiana Avenue (see attached diagram). Remaining boardwalk elements, such as the education area railing and the Meadowbrook Overlook, can be completed during cold weather conditions and will therefore remain on hold to focus on the most time sensitive portions. The construction completion deadline has been adjusted to December 19, 2014.

### **Flood Response:**

The Reach 20 Restoration site responded relatively well to recent flood conditions – the second time the site has experienced inundation since being restored in 2012-2013. Due to the prolonged nature of this year's flooding, District staff was afforded multiple opportunities to investigate the site and assess damage. Efforts have been made to revise planting plans to increase resiliency of certain species in areas that experienced extended inundation. District staff, in coordination with City staff and the vegetation contractor, determined alterations that would best fit the site based on this new information.

The site is also scheduled for an additional flood damage assessment, including coordination with FEMA to determine if identified damage is eligible for funding. Although the newly restored stream channel appears to have withstood the extreme conditions quite well, preliminary investigation has revealed that a portion of the woody vegetation planted during the stream restoration did not survive. All eligible damages and expenses will be reported to FEMA for further analysis.

District staff have also been working to complete a comprehensive stream restoration monitoring plan, and a site management plan with the City of St. Louis Park. These documents will establish the evaluation standards for the stream and wetland restoration, as well as memorialize a cooperative trail system management plan. Lastly, staff is researching maintenance protocol for trail systems of this nature. This information will inform the process of establishing a long term maintenance fund.

Board Members wanting to tour the site, or any additional questions, comments, or ideas related to the Reach 20 Restoration Project can be directed to Michael Hayman at [mhayman@minnehahacreek.org](mailto:mhayman@minnehahacreek.org) or 952.471.8226.

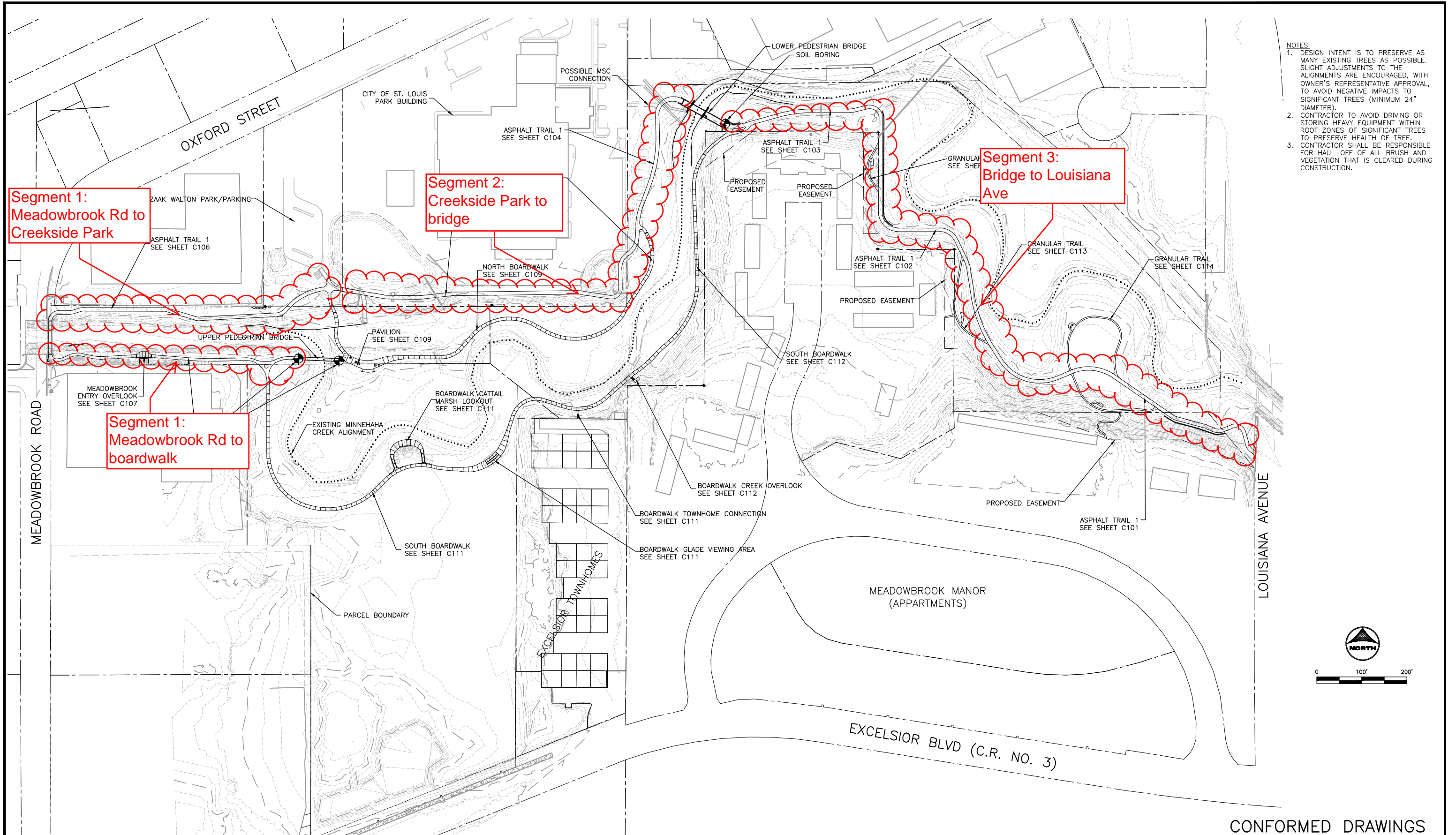

- NOTES:**
- DESIGN INTENT IS TO PRESERVE AS MANY EXISTING TREES AS POSSIBLE. SLIGHT ADJUSTMENTS TO THE ALIGNMENTS ARE ENCOURAGED, WITH OWNER'S REPRESENTATIVE APPROVAL, TO AVOID NEGATIVE IMPACTS TO SIGNIFICANT TREES (MINIMUM 24" DIAMETER).
  - CONTRACTOR TO AVOID DRIVING OR STORING HEAVY EQUIPMENT WITHIN ROOT ZONES OF SIGNIFICANT TREES TO PRESERVE HEALTH OF TREE.
  - CONTRACTOR SHALL BE RESPONSIBLE FOR HAUL-OFF OF ALL BRUSH AND VEGETATION THAT IS CLEARED DURING CONSTRUCTION.

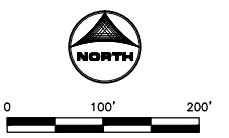

CONFORMED DRAWINGS  
AS OF 1/29/2014

DRAWN BY: JJC  
APPROVED: DWM  
CAD DATE: 1/29/2014 6:27:17 PM  
CAD FILE: O:\20120003.02\CAD\Drawings\G102 SITE PLAN.dwg

NO.	DATE	BY	REVISION DESCRIPTION
0	12/9/13	DWM	ALTERNATE BID SET ISSUED

I HEREBY CERTIFY THAT THIS PLAN, SPECIFICATION OR REPORT WAS PREPARED BY ME OR UNDER MY DIRECT SUPERVISION AND THAT I AM A DULY LICENSED PROFESSIONAL ENGINEER UNDER THE LAWS OF THE STATE OF MINNESOTA.

SIGNATURE: DANIEL W. MIELKE  
DATE: 12-09-2013 REG. NO. 50925



MINNEHAHA CREEK REACH 20 TRAILS INITIATIVE:  
FINAL DESIGN & CONSTRUCTION OVERSIGHT  
MINNEHAHA CREEK WATERSHED DISTRICT  
ST. LOUIS PARK, MINNESOTA

SITE PLAN

SHEET NO.  
G102